

RICHTER SCALE



H3F

Visit www.load-cell.co.za • T +27 (0)12 386 3065 • E: loadcells@richterscale.co.za



- H3F load cells are available in the capacities 0.1t~5t and 250lb~20Klb.
- Alloy steel, sealed by adhesive inside, oil-proof, waterproof and anti-corrosion, suitable for all kinds of environments.
- S beam design, tension and/or compression loading possible, easy installation, suitable for crane scale, mechanical conversion scale, hopper scale and other electronic weighing devices.
- Safe and anti-explosive product, can be used in atrocious environment and hazardous areas.

Features

- Capacity: 0.1t~5t;250lb~20Klb
- High accuracy
- Alloy steel construction
- Low profile

Accessory

- HL-3-001 • HL-3-002
- HL-3-003 • HL-3-004 • HL-3-005

Specifications

Capacity	t	0.1/0.25/0.5/0.75/1/1.5/2/2.5/5					
	lb	250/500/750/1K/1.5K/2K/2.5K/3K/5K/7.5K/10K/15K/20K					
Accuracy		C2	C3	A5S	A5M	B10S	B10M
Maximum number of verification intervals	n _{max}	2000	3000	5000	5000	10000	10000
Minimum load cell verification interval	v _{min}	E _{max} /5000	E _{max} /10000	E _{max} /15000	E _{max} /15000	E _{max} /10000	E _{max} /10000
Combined error	(%FS)	≤±0.030	≤±0.020	≤±0.018	≤±0.026	≤±0.035	≤±0.050
Creep	(%FS/30min)	≤±0.024	≤±0.016	≤±0.012	≤±0.017	≤±0.030	≤±0.040
Temperature effect on sensitivity	(%FS/10°C)	≤±0.017	≤±0.011	≤±0.009	≤±0.013	≤±0.030	≤±0.040
Temperature effect on zero	(%FS/10°C)	≤±0.023	≤±0.015	≤±0.010	≤±0.014	≤±0.030	≤±0.020
Output sensitivity	(mv/v)	3.0±0.008					
Input resistance	(Ω)	350±3.5					
Output resistance	(Ω)	351±2.0					
Insulation resistance	(MΩ)	≥5000(50VDC)					
Zero balance	(%FS)	1.0					
Temperature, compensated	(°C)	-10~+40					
Temperature, operating	(°C)	-35~+65					
Excitation, recommended	(V)	5~12(DC)					
Excitation, max	(V)	18(DC)					
Safe overload	(%FS)	150					
Ultimate overload	(%FS)	300					

Outline Dimension mm(inch)

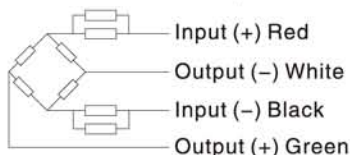
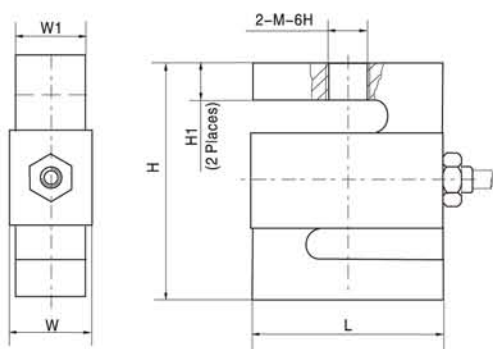

Wiring:

Adopt shielded, 4 conductor cable: Φ5mm
Standard cable length: 6m

Capacity	H	w	w1	L	H1	M
100kg	76.2(3)	20.6(0.81)	19(0.75)	50.8(2)	15.8(0.62)	M10×1.5
250kg	76.2(3)	20.6(0.81)	19(0.75)	50.8(2)	15.12(0.6)	M12×1.75
500kg	76.2(3)	20.6(0.81)	19(0.75)	50.8(2)	14.2(0.56)	M12×1.75
750kg	76.2(3)	20.6(0.81)	19(0.75)	50.8(2)	13.46(0.53)	M12×1.75
1000kg	76.2(3)	27(1.06)	25.4(1)	50.8(2)	13.24(0.52)	M12×1.75
1500kg	76.2(3)	27(1.06)	25.4(1)	50.8(2)	11.82(0.47)	M12×1.75
2000kg	108(4.25)	27(1.06)	25.4(1)	76.2(3)	26.7(1.05)	M18×1.5
2500kg	108(4.25)	27(1.06)	25.4(1)	76.2(3)	25.48(1)	M18×1.5
5000kg	108(4.25)	27(1.06)	25.4(1)	76.2(3)	20.26(0.8)	M18×1.5
250lb	76.2(3)	14.3(0.56)	12.7(0.5)	50.8(2)	15.69(0.62)	3/8-24UNF-2B
500lb	76.2(3)	20.6(0.81)	19(0.75)	50.8(2)	15.25(0.6)	1/2-20UNF-2B
750lb	76.2(3)	20.6(0.81)	19(0.75)	50.8(2)	14.95(0.59)	1/2-20UNF-2B
1K	76.2(3)	20.6(0.81)	19(0.75)	50.8(2)	14.4(0.57)	1/2-20UNF-2B
1.5K	76.2(3)	20.6(0.81)	19(0.75)	50.8(2)	13.75(0.54)	1/2-20UNF-2B
2K	76.2(3)	27(1.06)	25.4(1)	50.8(2)	13.4(0.53)	1/2-20UNF-2B
2.5K	76.2(3)	27(1.06)	25.4(1)	50.8(2)	13.03(0.51)	1/2-20UNF-2B
3K	76.2(3)	27(1.06)	25.4(1)	50.8(2)	12.39(0.49)	1/2-20UNF-2B
5K	108(4.25)	27(1.06)	25.4(1)	76.2(3)	27.18(1.07)	3/4-16UNF-2B
7.5K	108(4.25)	27(1.06)	25.4(1)	76.2(3)	25.78(1.01)	3/4-16UNF-2B
10K	108(4.25)	27(1.06)	25.4(1)	76.2(3)	23.88(0.94)	3/4-16UNF-2B
15K	140(5.51)	33.4(1.31)	31.8(1.25)	100(3.94)	31(1.22)	1-14UNS-2B
20K	177.8(7)	50.9(2)	49.3(1.94)	125.5(4.94)	39.9(1.57)	1-1/4-12UNF-2B